



Shasta
LAKESHORE RETREAT
www.shastalakeshoreretreat.com



TOUR OF RETREAT #14

Beautiful Expansive Vacation Rental
Shasta Lake, California

Updated: May 9, 2026

Part 2

Please also see Part 1, the Overview Brochure that goes with this at:

<https://shastalakeshoreretreat.com/Shasta-Lakeshore-Retreat-Info>



LAKESHORE RETREAT



- ◆ Expansive One+ Acres, ~2650 square feet Retreat
- ◆ Two Separate Large Entertaining/Family Areas
- ◆ 4 Bedrooms, 2 Bath
- ◆ Game Room with Pool Table, Darts, Couch, Table, & Ring Toss
- ◆ Sleeps up to 16, 9 Max Adults
- ◆ 1 King, 4 Queens, 1 Full, Twin over Full Bunk Bed, Twin Trundle, Futon
- ◆ Large Paved Loop Driveway room for multiple Boats and cars
- ◆ Minimal steps, access onto Both Floors
- ◆ Multiple Large Decks including one upper Screened Deck.
- ◆ 2 Wood Burning Fireplaces
- ◆ Close to Lake, Marinas, and Boat Ramps

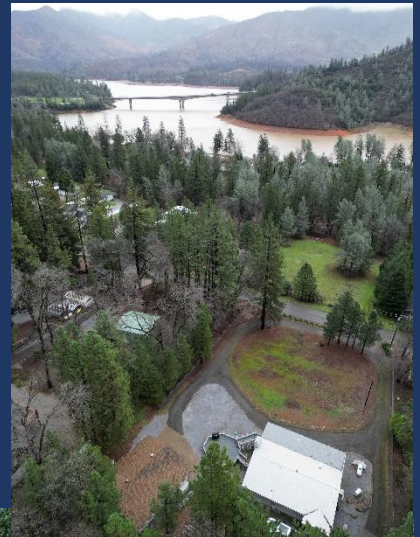



LAKESHORE RETREAT

◆ Upper Main Room/Kitchen

- Spacious Entertaining Area.
- Kitchen with Island & Bar Stools
- 10 Person Dining Room Table
- Wood Fireplace, Ceiling Fans, 55" Smart HDTV
- Expansive Windows overlooking the upper Deck and Spacious Yard
- Laundry Room with Freezer off Kitchen

LIFE IS BETTER AT THE LAKE





LAKESHORE RETREAT

◆ 2nd Entertaining Area on Lower Floor

- Spacious Entertaining Area
- Storage Cabinets & Sink
- 55" Smart DHTV
- Wood Fireplace
- Windows Looking out at Lower Patio & Grounds





LAKESHORE RETREAT

- ◆ Master Bedroom #1
 - Upper Floor
 - King bed, Nightstands, 43" HDTV, Closet
 - Mini-Spilt & Ceiling Fan



- ◆ Full Bath
 - Upper Floor
 - Tub/Shower combo, Sink, Toilet
 - Door to Common Hallway



- ◆ Guest Bedroom #2
 - Upper Floor
 - Two Queen beds, Nightstands, Lamps
 - Mini-Spilt, Closet



- ◆ Upper-Level Screened Deck
 - Outdoor Seating & Ceiling Fans





LAKESHORE RETREAT

- ◆ Guest Bedroom #3
 - Lower Floor
 - Queen & Full Bed, Dresser, Closet
 - Min-Split, Bench
- ◆ Guest bedroom #4
 - Lower Level
 - Bunk Bed with Twin over Full
 - Twin Trundle Bed
 - Dresser, Closet, Large Bean Bag Chair
- ◆ Bathroom #2
 - Lower Level
 - Shower, Sink, Toilet
 - Door to Common Hallway
- ◆ Large Game Room in Former Garage
 - Pool Table
 - Ping Pong
 - Corn Hole & More



- ◆ Lower Covered Porch & Uncovered Side Deck
 - Great Views of the Expansive Grounds & Mountains
 - Two Patio Tables and Seating for 10 (not in photo yet)
 - Gas Fire Pit, Heat Lamp, and Gas BBQ (not in photo yet)





Retreat 14
Upper Main Floor

Not to Scale,
Approximate Drawing

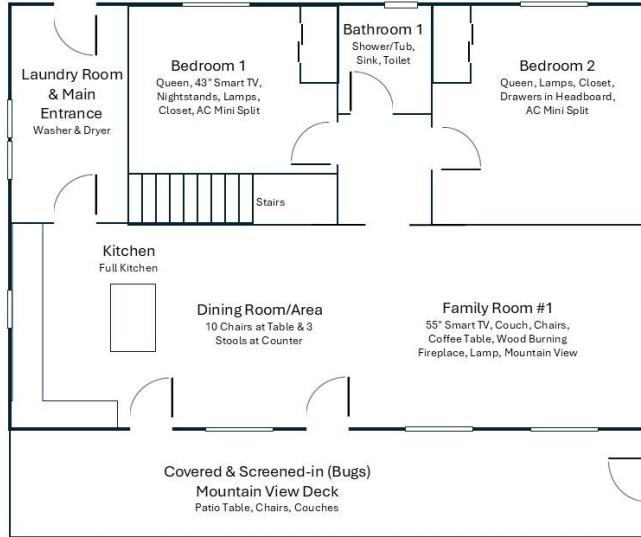

Outdoor
Deck Area
Another outdoor
deck with BBQ,
Heat Lamp, Fire Pit,
more Couches,
Chairs, Umbrella
and more not in
drawing.

Retreat 14
Lower Main Floor

Not to Scale,
Approximate Drawing

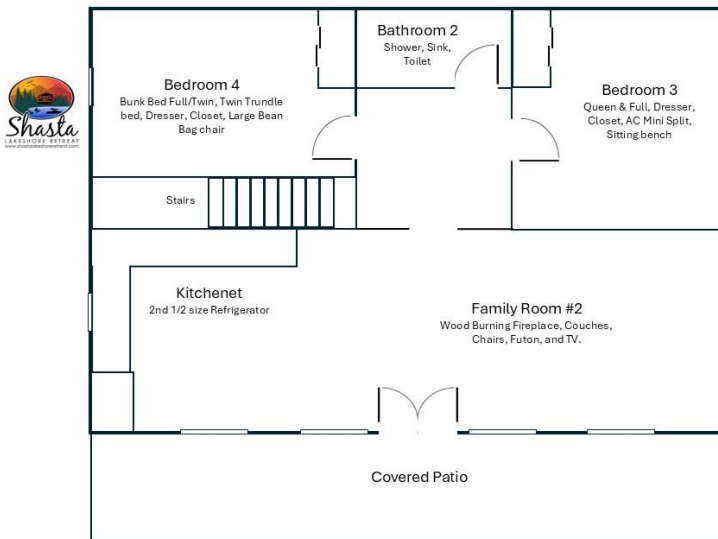

Retreat 14
Game Room

Not to Scale,
Approximate Drawing

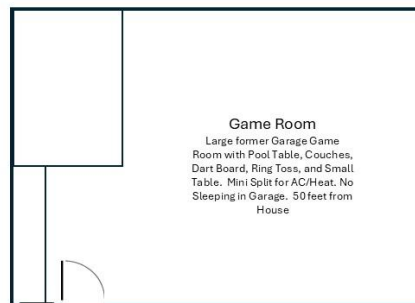



LAKESHORE RETREAT

- ◆ Large 1 Acre+ Lot
 - Large Paved Loop Driveway Great for Boats and Cars
 - Potential Wedding Venue
 - ½ Mile to Lake





LAKESHORE RETREAT



Shasta Area Information

SHASTA AREA INFORMATION WEBSITE

Shasta Lakeshore Retreat Website

SHASTA WEBSITE

Availability Calendar

SHASTA AVAILABILITY

Reservations

SHASTA RESERVATIONS



Shasta LAKESHORE RETREAT
www.shastalakeshoreretreat.com

Retreat Locations
Lakehead @ Shasta Lake

ANTLERS AREA
Retreat #11 & #16
Up to 14 Guests

LAKEVIEW AREA
Retreat #14
Up to 14 Guests

SUGARLOAF NORTH
Retreats #6, 7, 12, 15, 18, 19, & 20
Up to 95 Guests

SUGARLOAF SOUTH
Retreats #1, 2, 3, 4, 5, 8, 9, 10, & 17
Up to 110 Guests



Shasta LAKESHORE RETREAT
www.shastalakeshoreretreat.com

Lakeview Dr. Area
Retreat #14

LAKEVIEW AREA
Retreat #14
Up to 14 Guests

Reservations Available on All Three Platforms



- Click on Any Logo -



Shasta LAKESHORE RETREAT

Item	Feature	Retreat #14
1	~ Sq. Footage & # of Levels	~2640, 2 Floors, Large Lot
2	MAX. Sleep Number	16 (max# of adults = 9)
3	# Bedrooms/Lofts	4
4	Reservations/Stays	Now/Now
5	Bedroom 1 (Master)	King, Main Upper Floor, 43" Smart TV, Nightstands, Lamps, Closet, AC Mini Split
6	Bedroom 2	Two Queens, Main Upper Floor, Lamps, Closet, Drawers in Headboard, AC Mini Split
7	Bedroom 3	Queen & Full, Lower Floor, Dresser, Closet, AC Mini Split, Sitting bench
8	Bedroom 4	Bunk Bed Full/Twin, Twin Trundle bed, Dresser, Closet, Large Bean Bag chair
10	Extra Room	3
11	Family Area (off Kitchen)	55" Smart TV, Couch, Chairs, Coffee Table, Wood Burning Fireplace, Lamp, Upper Floor, Mountain View
12	Extra Bedding	Futon in Lower Family Room Area
13	# of Full Bathrooms	2
14	Bathroom 1	Upper Floor, Shower/Tub, Sink, Toilet, Door to Hallway
15	Bathroom 2	Lower Floor, Shower, Sink, Toilet, Door to Hallway
18	Kitchen	Refrigerator/Freezer w/Ice Maker, Gas Stove, Microwave, Sink, Dishwasher, Island on upper main level with 3 bar stools. 2nd partial kitchen also on lower level.
19	Refrigerator/Freezers	1 Large, 1 Med/Small
20	Fireplace or Stove	2 Wood Fire Places
21	Cooling	5 mini splits, ceiling fans
22	Heating	Central Heat upper floor, 5 mini splits
23	Inside Dining	10 chairs at table & 3 stools at counter
24	Outside Dining	Patio Furniture with seating for 10
25	Washer & Dryer	Yes
26	Fast Wi-Fi	Yes (ATT)
27	TV	3 Smart TV's(Streaming, Netflix, Peacock, Paramount +, Disney +, Hulu, HBO Max).
28	Indoor Games	Board, Card, Dice, Darts, Pool, Ring Toss
29	Outdoor Games	Corn Hole, Throwing Axe, Horse Shoes
30	Smoking or Vaping?	NO!
31	Car/Truck Parking (without boat)5	Up to 5 cars plus multiple boats. Great Parking. Best of all the Retreats.
32	Boat or ATV Trailer Parking15	Yes, Lots of it. Big Loop Driveway.
35	Gas BBQ (Propane Provided)	Yes
36	Heat Lamp (Propane Provided)	Yes
38	Gas Fire Pit (Propane Provided)	Yes
42	Trail/Path to Marina	Short 3-5 minute drive.
43	Lake Access/Trail	10 Min or 1/2 Mile Walk
46	Boat Slip at Marina	Sugarloaf Marina is Seasonal, normally open from May 1 to Sept 30. Next door to R1-5, 8-10, 17. Close walk from R6, R7, R12, R15, R18, R19, R20 Slips are \$55/night (2025). Antlers is open earlier and long and have better slips (more protected) and might be less in price. R11, and R16 should use Antlers.
47	House Location	Located in a very nice part of Lakehead on Lakeview drive which tends to have some of the larger homes on larger lots than other areas. About 1/2 between the town and the Sugarloaf Retreats. Very large lot with nice mountain view.
48	Distance to Lake (When Full)	~1/2 Mile
50	Shaded Deck	Yes, Screened Upper and Lower Level
51	Unshaded Deck	Yes, Side Deck
52	Pets Allowed4	Yes, Approved only Well Trained Dogs4, \$95 (plus tax)
53	Reservation Sites14	Our Website (75%), VRBO (10%), Airbnb (15%). Lower cost/fees on our website at https://shastalakeshoreretreat.com/reservations/
54	Minimum Nights	2-7 Nights depending on time of year
55	Whole Home Auto Generator	Yes (Most of Home)
56	Kids Stuff?	Port Crib, High Chair, Some Toys
57	Other (things not mentioned)	Two very spacious common areas. One upstairs and one down. Perfect for adults upstairs and younger group down. Looped paved driveway is about 1/4 mile in length around open area (could be area for wedding). Fully screened upper deck (bugs). Coffee Bar with Ninja Coffee maker(K-cup & drip coffee)
58	Stairs/Steps20	None required to lower level or but two to upper level and then stairs between inside.
59	2026 Pricing12	\$235-\$635 Per Night
60	Fire Safety	Fire Extinguishers on each floor, CO2 Detectors on Each Floor, Smoke Detectors in Bedrooms and Hallways
61	Other	Linens, Bedding, Pillows, Towels, Laundry Soap, Dish Soap, Ice Maker, Coffee Maker (Drip and Single Cup Keurig), Coffee filters, Toaster, Pots/Pans, Plates, Bowls, Glasses, Wine Glasses, Utensils, Board Games, Card Games, Dice, Corn Hole (most), Horse Shoes (some), Salt, Pepper, Some seasonings, Paper Towels*, Toilet Paper*, Air Freshener and Propane*. *Limited Qty, see guidebook for details.

1. BR=Bedroom, 2. LV=Lakeview 3. Stairs=Must take stairs to access. 4. Dogs must be well trained, no medical issues, not left alone in house unless in crate and never on furniture or beds. \$95 fee per pet. 5. If you have a boat/trailer/RV it you will be able to have 2-3 less cars. 7. Warm months as long as not prevented. 8. Sugarloaf Marina offers seasonal daily boat slips to public on first come basis (check if open). 9. Wood or Pellets provided. NO Outdoor fires on property. 10. Can be used throughout the house and on the decks. 11. From back of house to water level when lake is full. Can be several hundred yards if lake is low. Trail provided to water's edge. 12. Plus 10% lodging tax, cleaning fee \$225-\$495, Additional Guests Fees and any VRBO/Airbnb fees if not direct. Lowest price mid week in winter. Highest price weekends in the Summer and holidays. 14. Although there is a electrical hook up you can use if you discuss with us, you can not use to sleep in to increase the max number of guests. 15. No RV Trailers or Motorhomes. 16. Distance to water and view will vary depending on lake level. 17. Planned but ETA not known yet. Inquire. 18. View depends on lake level. 19. Always remember to bring properly fitted life vests with you for children until 12. Difficult to find right size at marina. 20. Please call to discuss concerns about elderly and handicapped access. 21. Use of Kayaks, Paddle Boards, the Floating Island, the Lake, Bikes, BBQ, Fireplace, Firepit, Heat Lamps, Hot Tubs and all other activities are at your own risk. Call us with questions. (Updated 1-20-2026)