



# TOUR OF RETREAT #6

Lake House Vacation Rental  
Shasta Lake, California

Updated: October 22, 2024

Part 2

Please also see Part 1, the Overview Document that goes with this at:

<https://shastalakeshoreretreat.com/Shasta-Lakeshore-Retreat-Info>



## LAKE SHORE RETREAT



### RETREAT #6 (~1410 Square Feet)

- ◆ Short Walk to lake and other homes.
- ◆ Sleeps up to 12 (Max of 9 Adults)
- ◆ 1 King, 4 queens, Pull out couch
- ◆ 3 Bedrooms, 3 Full Bath, Kitchen/Main Family Room
- ◆ Very Large 3<sup>rd</sup> Bedroom
- ◆ Large deck with BBQ, Gas Fire Pit, Heat Lamp
- ◆ Good level parking.







## LAKE SHORE RETREAT

### TOUR OF RETREAT #5:

- ◆ Main Room/Kitchen
  - Very comfortable and sizable front room and kitchen area.
  - L-Shaped Couch/Sleeper Sofa. Lots of seating. 52" HDTV.
  - Full kitchen including electric stove/oven range, dishwasher, refrigerator, and microwave
  - Dining table off kitchen.
  - Island with two bar stools
  - Nice wood flooring throughout.





## LAKESHORE RETREAT



- ◆ Master Bedroom #1
  - King bed, Dresser, Nightstand, Ceiling Fan, Closet.
  - Full Bath with access from Bedroom



- ◆ Bedroom #2
  - Queen bed, nightstand, dresser, and closet
- ◆ Bathroom #2
  - Full bath with access from hallway
  - Shower/Tub



- ◆ Bedroom #3 Suite on Lower Floor
  - Three Queen Beds
- ◆ Bathroom #2
  - Full bath on main floor with access by all with Tub/Shower combo



## Retreat 6, Main Upper Floor

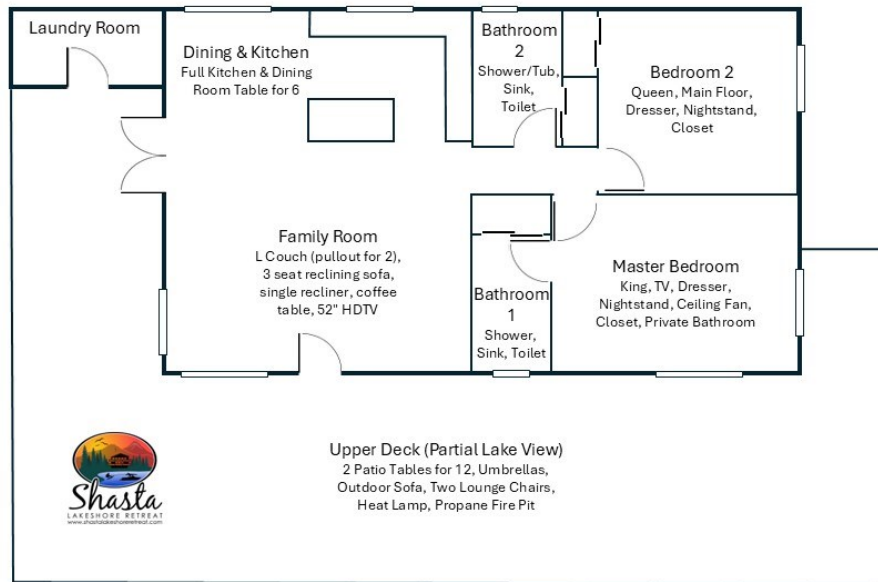

Not to Scale, Approximate Drawing

## Retreat 6, Lower Level

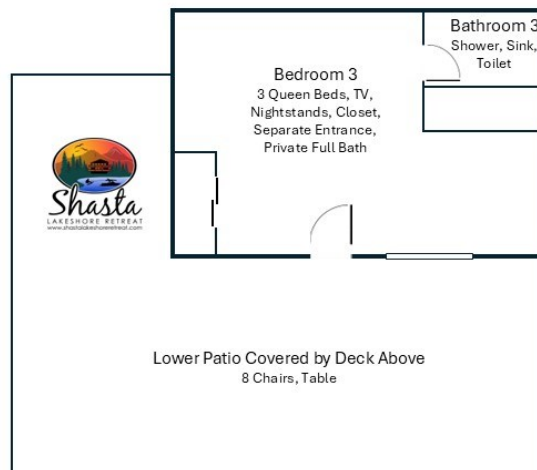

Not to Scale, Approximate Drawing





## LAKE SHORE RETREAT



### ◆ 50' Wide Deck

- Great Views of the Mountains & Wildlife that pass through
- Two Patio Tables for seating of 12, BBQ
- Heat Lamp, Gas Fire Pit, Umbrellas





# Shasta LAKESHORE RETREAT

## Availability Calendar



## Reservations



## Shasta Area Information



## Shasta Lakeshore Retreat Website







LAKE SHORE RETREAT

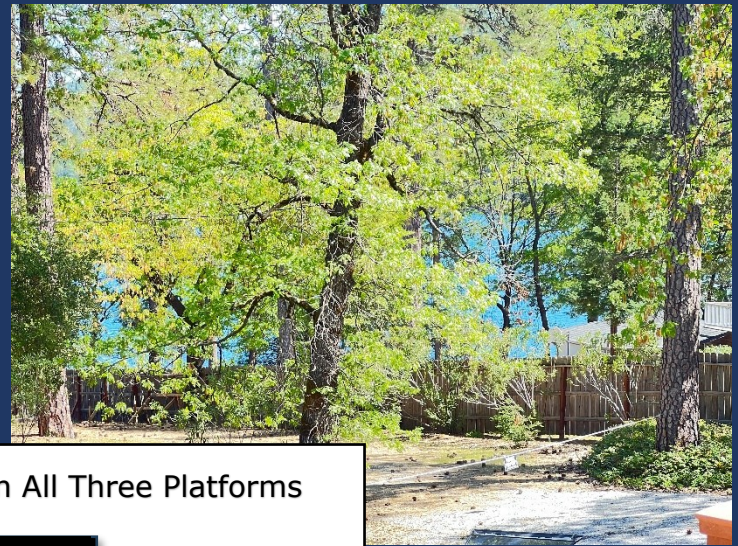

Reservations Available on All Three Platforms



- Click on Any Logo -

Please also see Part 1, the Overview Brochure that goes with this at:  
<https://shastalakeshoreretreat.com/Shasta-Lakeshore-Retreat-Info>





# LAKE SHORE RETREAT

#	Item	Retreat #6
1	~ Sq. Footage & # of Levels	~1410, 2 Floors
2	MAX. Sleep Number	12(max # of adults =9)
3	# Bedrooms/Lofts	3
4	Reservations/Stays	Now/Now
5	Bedroom 1 (Master)	King, Main Floor, TV, Dresser, Nightstand, Ceiling Fan, Closet, Private Bathroom.
6	Bedroom 2	Queen, Main Floor, Dresser, Nightstand, Closet
7	Bedroom 3	3 Queen Beds for up to 6, TV, Downstairs, Separate Door Access, Attached BR, Closet
11	Family Area (off Kitchen)	L Couch (pullout for 2), 3 seat reclining sofa, single recliner, coffee table, 52" HDTV
12	Extra Bedding	The pull out sofa in Family Area
13	# of Full Bathrooms	3
14	Bathroom 1	Main Floor, Shower, Sink, Toilet, Door to Master
15	Bathroom 2	Main Floor, Shower/tub, Sink, Toilet, Door to Common Area
16	Bathroom 3	Lower Fl, Stairs, Shower, Toilet, Sink, Entry via BR 3
18	Kitchen	Refrig/Freezers w/Ice Maker, Stove, Oven, Microwave, Dishwasher, Bar Island
19	Refrigerator/Freezers	1 Large
21	Cooling	Central Air, Ceiling Fans, Fans
22	Heating	Central Heat
23	Inside Dining	6 at Table, 3 at Counter
24	Outside Dining	12 at 2 Tables
25	Washer & Dryer	Yes
26	Fast Wi-Fi	Yes (20Mdown 3Mup)
27	TV	2 Smart HDTVs (Firestick Streaming)
28	Indoor Games	Board, Card, Dice, Etc.
29	Outdoor Games	Corn Hole, Horse Shoes
30	Smoking or Vaping?	NO!
31	Car/Truck Parking (if no boat)5	2 on upper driveway, 2 on lower, 1 on street
32	Boat or ATV Trailer Parking15	On flat gravel driveway , good for 2 boats & RV Electric Hookup14
35	Gas BBQ (Propane Provided)	Yes
36	Heat Lamp (Propane Provided)	Yes
37	Outside Ice Chest (Summer)	
38	Gas Fire Pit (Propane Provided)	Yes
42	Trail/Path to Marina	Short Walk/Drive Via Road, Paths
43	Lake Access/Trail	Short Walk/Drive Via Road, Paths
46	Boat Slip at Marina	Sugarloaf Marina is Seasonal, normally open from May 1 to Sept 30. Next door to R1-5, 8-10, 17. Close walk from R6, R7, R12, R15, R18, R19 Slips are \$55/night (2024). Antlers is open earlier and long and have better slips (more protected) and might be less in price. R11, and R16 should use Antlers.
47	House Location	Slight Lakeview18 through trees. Lake Drive. One row of homes in-between Retreat and lake. Sugarloaf Area near Marina8 and Boat Ramps. 3-5min walk other Retreats. Closet to R19, R15, R12, and R7
48	Distance to Lake (When Full)	400 feet11
50	Shaded Deck	Yes, via umbrellas
51	Unshaded Deck	Yes
52	Pets Allowed4	Yes, Approved only Well Trained Dogs4, \$95 (plus tax)
53	Reservation Sites14	Our Website (70%), VRBO (15%), Airbnb (15%). Lower cost/fees on our website at <a href="https://shastalakeshoreretreat.com/reservations/">https://shastalakeshoreretreat.com/reservations/</a>
54	Minimum Nights	2-7 Nights depending on time of year
57	Other (things not mentioned)	Lower floor/Suite has dedicated entrance. No internal stairs between levels.
58	Stairs/Steps20	Main Floor - 3 steps from parking
59	2025 Pricing12	~\$171-\$559 a Night12
60	Fire Safety	Fire Extinguishers on each floor, CO2 Detectors on Each Floor, Smoke Detectors in Bedrooms and Hallways
61	Other	Linens, Bedding, Pillows, Towels, Laundry Soap, Dish Soap, Ice Maker, Coffee Maker (R4, R8, R14 has Keurig, bring your favorite cups), Coffee filters, Toaster, Pots/Pans, Plates, Bowls, Glasses, Wine Glasses, Utensils, Board Games, Card Games, Dice, Corn Hole, Horse Shoes, Salt, Pepper, Some seasonings, Paper Towels*, Toilet Paper*, Air Freshener and Propane*. *Limited Qty, see welcome book for details.

1. BR=Bedroom, 2. LV=Lakeview 3. Stairs=Must take stairs to access. 4. Dogs must be well trained, no medical issues, not left alone in house unless in crate and never on furniture or beds. \$95 fee per pet. 5. If you have a boat/trailer/RV it you will be able to have 2-3 less cars. 7. Warm months as long as not prevented. 8. Sugarloaf Marina offers seasonal daily boat slips to public on first come basis (check if open). 9. Wood or Pellets provided. NO Outdoor fires on property. 10. Can be used throughout the house and on the decks. 11. From back of house to water level when lake is full. Can be several hundred yards if lake is low. Trail provided to water's edge. 12. Plus 10% lodging tax, cleaning fee \$225-\$495, Additional Guests Fees and any VRBO/Airbnb fees if not direct. Lowest price mid week in winter. Highest price weekends in the Summer and holidays. 14. Although there is a electrical hook up you can use if you discuss with us, you can not use to sleep in to increase the max number of guests. 15. No RV Trailers or Motorhomes. 16. Distance to water and view will vary depending on lake level. 17. Planned but ETA not known yet. Inquire. 18. View depends on lake level. 19. Always remember to bring properly fitted life vests with you for children until 12. Difficult to find right size at marina. 20. Please call to discuss concerns about elderly and handicapped access. 21. New to our collection of homes, Preliminary Info, replacing a current Retreat 8 effective Oct 2, 2024. 22. New to our collection of homes, Preliminary Info, replacing a current Retreat 17 effective Oct 2, 2024. Call us with questions. (Updated 9-11-2024)