



TOUR OF RETREAT #18

Amazing Lake View Home
Shasta Lake, California

Updated: April 15, 2025, Part 2

Please also see Part 1, the Overview Brochure that goes with this at:
<https://shastalakeshoreretreat.com/Shasta-Lakeshore-Retreat-Info>



LAKESHORE RETREAT



- ◆ Amazing Lake Views from Both Decks & the Home
- ◆ Short Walk/Drive to Marina, Boat Ramp and Lake
- ◆ ~2000 square feet, 4 Bedrooms, 3 Full Baths
- ◆ Sleeps 10 (1 King, 1 Queen, Twin Bunk Beds, Futon, Sleeper Sofa), 9 Max Adults
- ◆ Good parking for Cars and Trucks.
- ◆ Lots of great flat parking for Cars & Trucks.
- ◆ 2 Fireplaces
- ◆ Central Heating & Air Conditioning

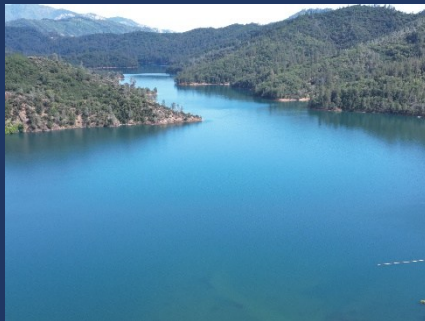



LAKESHORE RETREAT

◆ Main Room/Kitchen

- Awesome Elevated Views of the Lake!
- Modern Kitchen Stove/Oven Range, Dishwasher, Refrigerator, Freezer, and Microwave.
- Wood Burning Fireplace
- Dining Table for 6 plus 3 at Kitchen Island





LAKESHORE RETREAT

◆ Master Bedroom (Upper, Main Floor)

- King Bed, Nightstands, Lamps, Dresser, Ceiling Fan & Closet
- Slider to Deck
- Master Bath Door to Bedroom
- More/updated photos coming.



◆ Bedroom #2 (Upper, Main Floor)

- Queen, Nightstands, Dresser, Ceiling Fans, Closet, Futon (may change)





LAKESHORE RETREAT

- ◆ Bedroom #3 (Upper, Main Floor)
 - Smaller Bedroom
 - Twin Bunk Beds
 - No Current Photo (Coming)



- ◆ Bedroom #4/Suite/2nd Family Room (Lower Floor)
 - Pull Out Sofa, Futon, Bunk Beds to be added
 - Fireplace, TV, Dresser, Ceiling Fan
 - More/Updated Photos Coming





LAKESHORE RETREAT

- ◆ Bathroom #1
 - Shower, Toilet and Sink
 - Upstairs, Master Bedroom



- ◆ Bathroom #2
 - Shower/Tub, Toilet, Sink
 - Upstairs, Door to Hallway



- ◆ Bathroom #3
 - Shower/Tub, Toilet, Sink
 - Door to Lower Floor Suite



NOTE: Home is opening Memorial Day, 2025 with first guests so some items may change as we complete the prep for guests.



Retreat 18, Upper Main Floor

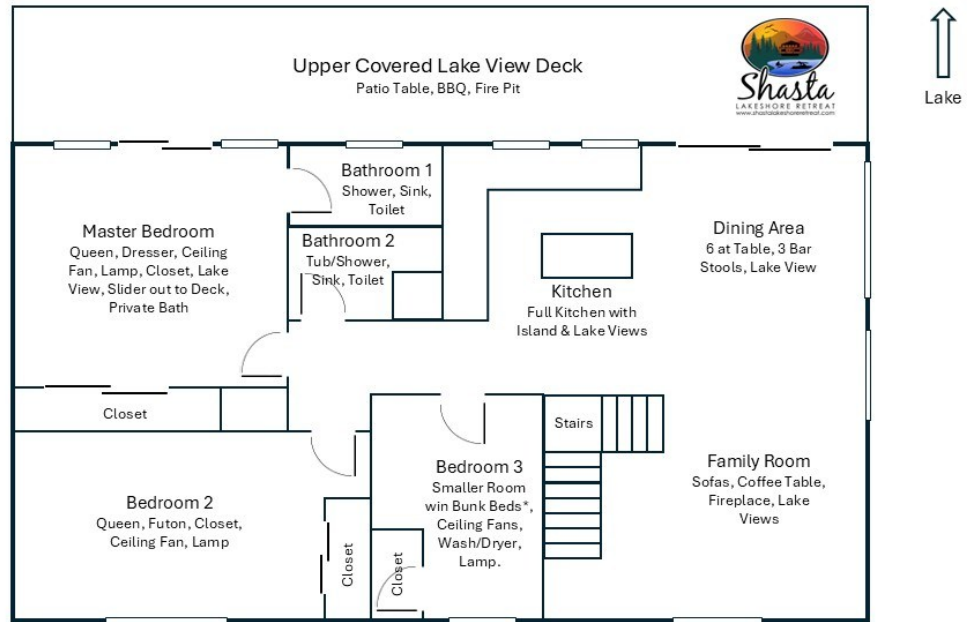

* Beds Style may change.

Not to Scale, Approximate Drawing

Retreat 18, Lower Floor

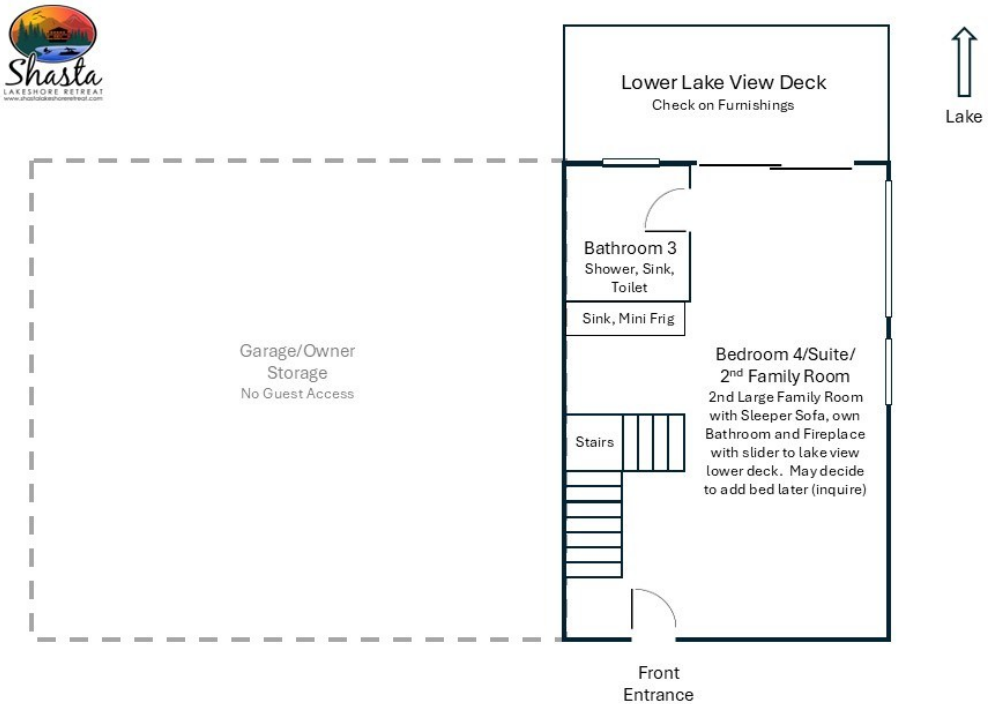

Not to Scale, Approximate Drawing



LAKESHORE RETREAT

- ◆ Endless views of Lake
 - Unobstructed Views of Sugarloaf area and the Lake
 - Two fully covered large decks.
 - Hammock, Lots of Parking (no boats/trailers)





LAKESHORE RETREAT

SUGARLOAF RETREATS

- R1: Retreat 1
- R2: Retreat 2
- R3: Retreat 3
- R4: Retreat 4
- R5: Retreat 5
- R6: Retreat 6
- R7: Retreat 7
- R8: Retreat 8
- R9: Retreat 9
- R10: Retreat 10
- R12: Retreat 12
- R15: Retreat 15
- R17: Retreat 17
- R18: Retreat 18
- R19: Retreat 19

Retreat #11, #14, #16

Sugarloaf Area Lakehead, CA

Sugarloaf County Boat Ramp Road
Sugarloaf County Public Boat Ramp (When Lake is Lower)
Sugarloaf Resort Boat Ramp & Marina
Daisy Lane Retreats

Note: Not to Scale & Only Approximate. Water level varies greatly.

Lake Level Varies. This is when lake is Full

Shasta Area Information

Shasta Lakeshore Retreat Website

Availability Calendar

Reservations

Shasta LAKESHORE RETREAT
www.shastalakeshoreretreat.com

Retreat Locations Lakehead @ Shasta Lake

ANTLER AREA
Retreat #11 & #16
Up to 14 Guests

LAKEVIEW AREA
Retreat #14
Up to 14 Guests

SUGARLOAF NORTH
Retreats #6, 7, 12, 15, 18, & 19
Up to 80 Guests

SUGARLOAF SOUTH
Retreats #1, 2, 3, 4, 5, 8, 9, 10, & 17
Up to 110 Guests

Shasta LAKESHORE RETREAT
www.shastalakeshoreretreat.com

Sugarloaf North Lakehead, CA

Sugarloaf County Boat Ramp Road
Sugarloaf County Public Boat Ramp (When Lake is Lower)
Sugarloaf Resort Boat Ramp & Marina
Sugarloaf Cottages (Small Cabins)

- R6: Retreat 6
- R7: Retreat 7
- R12: Retreat 12
- R15: Retreat 15
- R17: Retreat 17
- R18: Retreat 18
- R19: Retreat 19

Note: Not to Scale & Only Approximate. Water level varies greatly.

Reservations Available on All Three Platforms





Direct, Save Fees

- Click on Any Logo -



Shasta LAKESHORE RETREAT

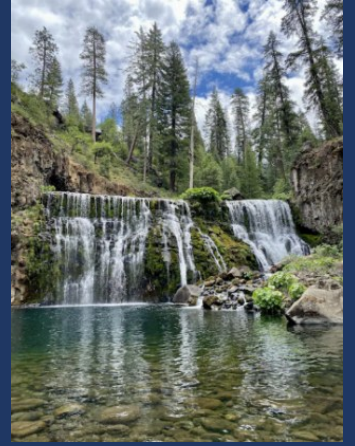



SHASTA LAKESHORE RETREAT

#	Item	NEW: Retreat #18 - PRELIM
1	~ Sq. Footage & # of Levels	~2000, 2 Floors, Lake Views
2	MAX. Sleep Number	10 (max# of adults = 9)
3	# Bedrooms/Lofts	4
4	Reservations/Stays	Now/2025
5	Bedroom 1 (Master)	Queen, Dresser, Ceiling Fan, Lamp, Closet, Lake View, Slider out to Deck, Private Bath
6	Bedroom 2	Queen, Futon, Closet, Ceiling Fan, Lamp
7	Bedroom 3	Twin Bunk Beds, Ceiling Fans, Wash/Dryer, Lamp, Closet
8	Bedroom 4	2nd Large Family Room with Sleeper sofa, own bathroom and fireplace with slider to lower deck.
11	Family Area (off Kitchen)	Sofas, Coffee Table, Fireplace
13	# of Full Bathrooms	3
14	Bathroom 1	Shower, Sink, Toilet, Door to Master
15	Bathroom 2	Tub/Shower, Sink, Toilet, Door to Hallway
16	Bathroom 3	Shower, Sink, Toilet, Door to Large Family Room/Bedroom Suite
18	Kitchen	Refrigerator/Freezer w/Ice Maker, Stove, Microwave, Sink, Dishwasher, Views of Lake
19	Refrigerator/Freezers	1 Large
20	Fireplace or Stove	Wood Burning Fireplace x2
21	Cooling	Central Air, Ceiling Fans
22	Heating	Central Heat
23	Inside Dining	6 at Table, 3 Bar Stools
24	Outside Dining	6 at Patio Table, May add another.
25	Washer & Dryer	Yes
26	Fast Wi-Fi	Yes (Fast Starlink)
27	TV	Yes, More Info Later
28	Indoor Games	Board Games, Cards
29	Outdoor Games	Cornhole
30	Smoking or Vaping?	NO!
31	Car/Truck Parking (without boat)5	Up to 4 cars. No trailers or boats.
32	Boat or ATV Trailer Parking15	No, We will have you park elsewhere
35	Gas BBQ (Propane Provided)	Yes
38	Gas Fire Pit (Propane Provided)	Yes
42	Trail/Path to Marina	5-10 Min Walk, 2 Min Drive
43	Lake Access/Trail	Short Walk/Drive Via Road, Paths, Hill Steep
46	Boat Slip at Marina	Sugarloaf Marina is Seasonal, normally open from May 1 to Sept 30. Next door to R1-5, 8-10, 17. Close walk from R6, R7, R12, R15, R18, R19 Slips are \$55/night (2024). Antlers is open earlier and long and have better slips (more protected) and might be less in price. R11, and R16 should use Antlers.
47	House Location	Sugarloaf area of Lakehead, with a 5-10 min walk to lake and marina but steep hill. Short walk to all other retreats excepts #11, #14, #16. Closest to Retreat 1-5,8-10, 17.
48	Distance to Lake (When Full)	~400 yards
49	Hammocks (Summer)	Yes
50	Shaded Deck	Yes, Both Levels
51	Unshaded Deck	Yes, some
52	Pets Allowed4	Yes, Approved only Well Trained Dogs4, \$95 (plus tax)
53	Reservation Sites14	Our Website (70%), VRBO (15%), Airbnb (15%). Lower cost/fees on our website at https://shastalakeshoreretreat.com/reservations/
54	Minimum Nights	2-7 Nights depending on time of year
55	Whole Home Auto Generator	Yes
57	Other (things not mentioned)	Lake Views are incredible. Good Parking at house but the steep nature of the road leading to the house and the sharp turns prevent the parking of a boat at the house. Shasta Lakeshore Retreat will provide other areas to park.
58	Stairs/Steps20	~1 step to front door and lower level. Main floor up one flight.
59	2025 Pricing12	\$194 - \$628 per Night
60	Fire Safety	Fire Extinguishers on each floor, CO2 Detectors on Each Floor, Smoke Detectors in Bedrooms and Hallways
61	Other	Linens, Bedding, Pillows, Towels, Laundry Soap, Dish Soap, Ice Maker, Coffee Maker (R4, R8, R14 has Keurig, bring your favorite cups), Coffee filters, Toaster, Pots/Pans, Plates, Bowls, Glasses, Wine Glasses, Utensils, Board Games, Card Games, Dice, Corn Hole, Horse Shoes, Salt, Pepper, Some seasonings, Paper Towels*, Toilet Paper*, Air Freshener and Propane*. *Limited Qty, see welcome book for details.

1. BR=Bedroom, 2. LV=Lakeview 3. Stairs=Must take stairs to access. 4. Dogs must be well trained, no medical issues, not left alone in house unless in crate and never on furniture or beds. \$95 fee per pet. 5. If you have a boat/trailer/RV it you will be able to have 2-3 less cars. 7. Warm months as long as not prevented. 8. Sugarloaf Marina offers seasonal daily boat slips to public on first come basis (check if open). 9. Wood or Pellets provided. NO Outdoor fires on property. 10. Can be used throughout the house and on the decks. 11. From back of house to water level when lake is full. Can be several hundred yards if lake is low. Trail provided to water's edge. 12. Plus 10% lodging tax, cleaning fee \$225-\$495, Additional Guests Fees and any VRBO/Airbnb fees if not direct. Lowest price mid week in winter. Highest price weekends in the Summer and holidays. 14. Although there is a electrical hook up you can use if you discuss with us, you can not use to sleep in to increase the max number of guests. 15. No RV Trailers or Motorhomes. 16. Distance to water and view will vary depending on lake level. 17. Planned but ETA not known yet. Inquire. 18. View depends on lake level. 19. Always remember to bring properly fitted life vests with you for children until 12. Difficult to find right size at marina. 20. Please call to discuss concerns about elderly and handicapped access. 21. New to our collection of homes, replacing a previous Retreat 8. 22 New to our collection of homes, replacing a previous Retreat 17. Call us with questions. (Updated 10-21-2024)

